

⚠ WARNING

Before operating this equipment, please read this manual carefully and retain this for future reference. This equipment may cause harm, if not installed and used in accordance with this manual.

Attention to Users

⚠ CAUTION This equipment may cause harm, if not installed and used in accordance with following instructions.

- Keep the maximum weight capacity. When setting up this equipment more than capacity which may cause damage or harm to users.
- Firmly tighten the lock knob and screw, 1/4 inch camera screw, pan handle.
- Do not dismantle or modify which may cause harmful to users and itself. If any problem happened, please seek for nearest dealers.

Attachment of the Accessory

Attachable accessory is required as less than 1kg weight with 1/4 camera screw. Do not use over capacity accessory.

Set up the LCD Monitor

- 1** ACCESSORY SUPPORT can be attached any angle to the head.
 - When usage of UNDER MOUNT for JB-30, following instruction is required. Please make sure this instruction, otherwise hit to the flame which cause damage of equipment.
 - ① Loosen the AS-5 head lock knob, remove it from flame.
 - ② Attach to the flame as upside down, firmly tighten AS-5 head lock knob.
- 2** Position the LCD Monitor with AS-5 head 1/4 inch camera screw and firmly tighten.
- 3** AS-5 head can be adjusted any angle by pan handle. Or loosen the AS-5 head lock knob for positioning on the flame.
 - AS-5S for Sachtler DV-12 / VIDEO 18 · 20 · 25
 - AS-5V for Vinten all Vision series

Description of Parts

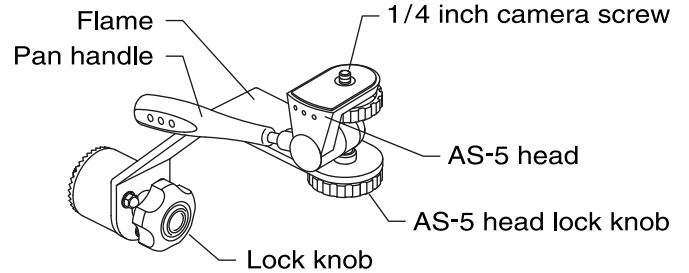

Attachment of the Accessory

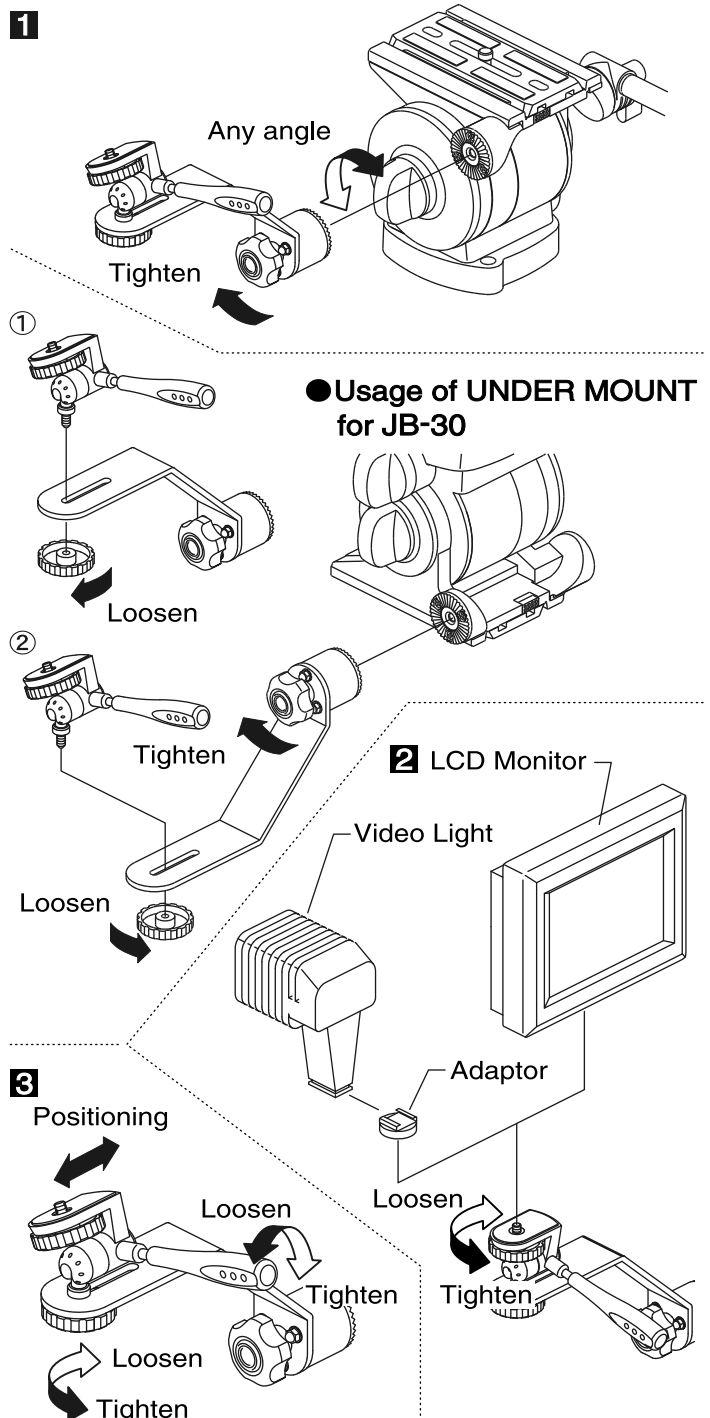

Manufacturer :

HEIWA SEIKI KOGYO CO.,LTD.

978-1,Nishibukuro, Yashio-City,Saitama,340-0833 Japan

TEL : 048-995-1301

FAX : 048-997-0804

<http://www.libec.co.jp>